

Organizatori:



Pokrovitelji:



Donator:



Sponzori:



Tehnički sponzori:



# PROJECT PROJECT

- BINA project started in 2006 as a week-long event, and during these 10 years has grown into a month-long festival. BINA is a platform which promotes contemporary architecture in the broadest sense, networking among the professionals and encourages interdisciplinary cultural exchange.
- Belgrade International Architecture Week - BINA was created under the auspices of two organizations: one NGO - Association of Belgrade Architects and the Cultural Center of Belgrade, a city cultural institution. Since its founding, BINA has partnered with more than 400 local and international institutions, organizations and individuals.
- BINA is a festival with very diverse types of events: exhibitions, lectures, debates, conferences, workshops for children, themed architectural walks, film program and performances ... with up to 17,000 visitors (data from 2015)

# BINA



BINA team: Jelena Ivanović Vojvodić, Danica Jovović Prodanović, Tanja Conley, Ivan Kucina, Darko Marušić and Ružica Sarić, together with a large number of staff, students, volunteers, partners and friends of the project.

All these years BINA programs are organized under the auspices of: City of Belgrade, Ministry of Culture of the Republic of Serbia, Serbian Chamber of Engineers and with the support of foreign cultural centers, EUNIC cluster, embassies, as well as numerous sponsors and donors

**[www.bina.rs](http://www.bina.rs)**

## BINA TIM BINA TEAM



## ORGANIZACIJA ORGANIZATION

DRUŠTVO ARHITEKATA BEOGRADA ASSOCIATION OF BELGRADE ARCHITECTS  
KULTURNI CENTAR BEOGRADA CULTURAL CENTRE OF BELGRADE  
SUORGANIZATORI CO-ORGANIZERS

ARHITEKTONSKI FAKULTET UNIVERZITETA U BEOGRADU  
UNIVERSITY OF BELGRADE FACULTY OF ARCHITECTURE  
CENTAR ZA PROMOCIJU NAUKE CENTRE FOR PROMOTION OF SCIENCE  
E UNIC SRBIJA E UNIC SERBIA

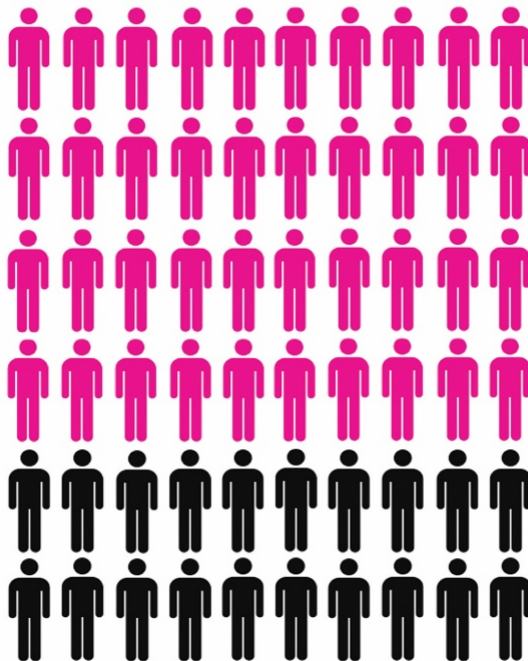

Exhibition BINA DECADE, 2015.

## UČESNICI AUTHORS

PREKO **700** UČESNIKA ZA **9** GODINA  
OVER **700** AUTHORS IN **9** YEARS

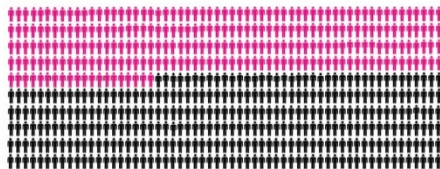

## PUBLIKA AUDIENCE

U PROSEKU **10 000** POSETILACA SVAKE GODINE  
ON AVERAGE **10 000** VISITORS EACH YEAR

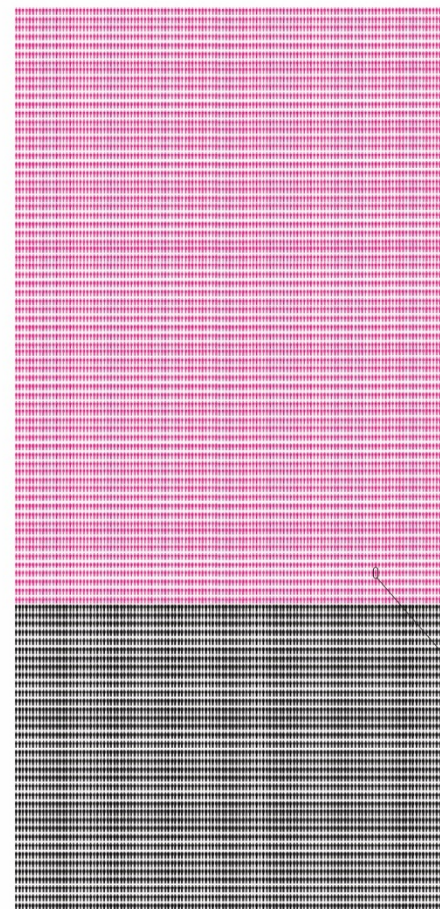

**Nevenka Dular**  
najčešći posetilac od 2011  
the most frequent visitor since 2011

Nevenkin BINAmetar :



10.96 km



225.37 km



35.13 km

# CONCEPT **BINA** CONCEPT

- BINA project was launched as an invitation to professional and general public to reflect on the quality of the architecture and urbanism, but also to discuss criteria and values that determine the quality of the built environment.
- At the same time, BINA, thanks to the variety of its' customized programs, has educative character and intends to improve general knowledge in the field of architecture and urban planning with special focus on raising public awareness of architectural culture and culture in general.
- BINA is also a business event that brings together a large number of professionals and students with aim to promote: innovation and creativity in the field of architecture and urban planning.
- BINA is non-profit festival and all BINA programs are free



# FESTIVAL

# BINA

# FESTIVAL

- Multidisciplinary  
FESTIVAL of  
ARCHITECTURE  
organized annually
- EXHIBITIONS
- LECTURES
- GUIDED TOURS
- WORKSHOPS
- CONFERENCES
- PERFORMANCES
- BINA ON TOUR



# BINA





# БИНА



Scandinavian Housing, 2010



Pedestrian Zone Novi Sad, 2015



Doomed Architect, Bogdan Bogdanović, 2011



# CITIZENS AND CITY MAKING 2015 INTERNATIONAL CONFERENCE

**CITIZENSHIP AND CITY MAKING** (2015) conference resumes the ten-year long effort to bring together designers, architects, urban planners, public and civil administrators, citizens, and organizations of civil society in the process of ongoing improvement of the urban environment. Having in mind the actual practice, conference mostly aimed to define the role of citizens in mobilizing city makers towards creating conditions for just, inclusive and sustainable urban development.



# 6INN2 ON TOUR



# INTERNATIONAL **GINA** COOPERATION

## UNFINISHED MODERNIZATIONS - Between Utopia and Pragmatism

Two-year collaborative project **UNFINISHED MODERNIZATIONS - BETWEEN UTOPIA AND PRAGMATISM** (2010/2012) commenced on the initiative of the CAA/Croatian Architects' Association in collaboration with partners Maribor Art Gallery (Slovenia), Museum of Architecture and Design (Slovenia), Belgrade Architects Association (Serbia), Coalition for Sustainable Development (Macedonia) and Oris-House of Architecture (Croatia).





# BINA

**SCANDINAVIAN PAVILION/BINA KABINA** /Workshop space, was designed and built (2014/15) as a result of the Serbian/Norwegian student workshop mentored by professors from both countries and supported by the Nordic Culture Fund, Module for production-based activities, Serbian Ministry of Culture, City of Belgrade, University of Belgrade and number of donors and sponsors

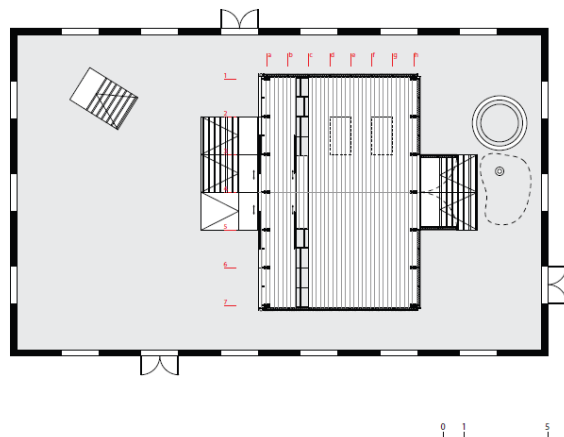

# БИНӘ





# BYNA

## TO BE CONTINUED...

