

LANDSCAPES OF THE ANTHROPOCENE

Encounters in More-than-Human Worlds

Future Architecture

*Tiago Torres-Campos
tiago.t.campos@ed.ac.uk*

1.

Encounters among Geologic Change



Source: National Geographic



Source: Reddit



Source: The Guardian



Archipelago of Rio de Janeiro
Tiago Torres-Campos, 2013

2.

Changing the Way We Think

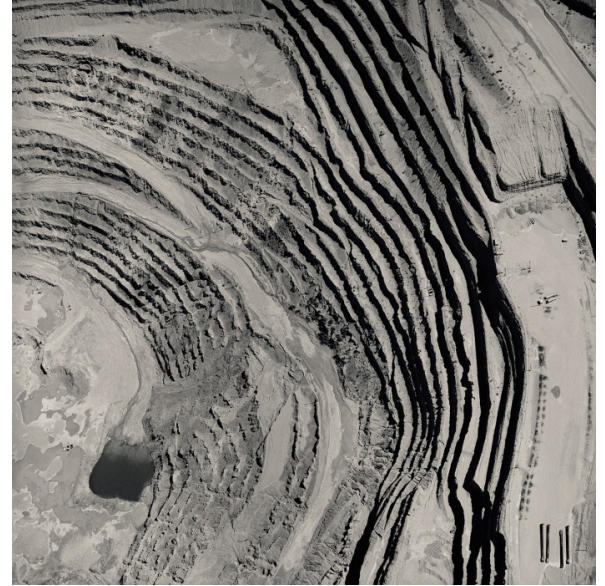

Black Maps
David Maisel, 1985

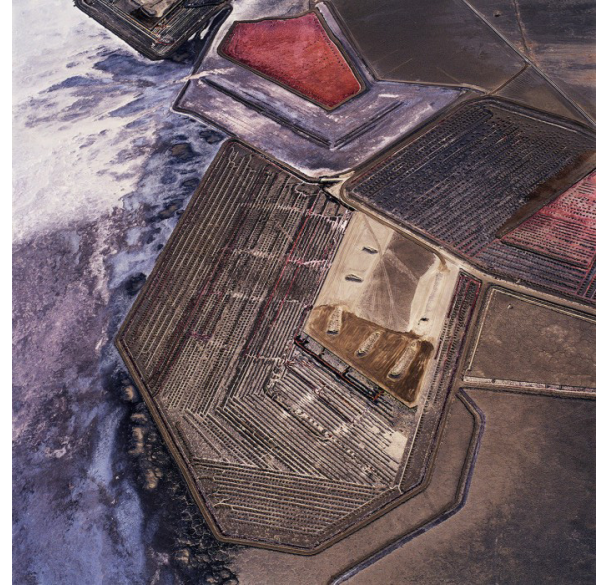
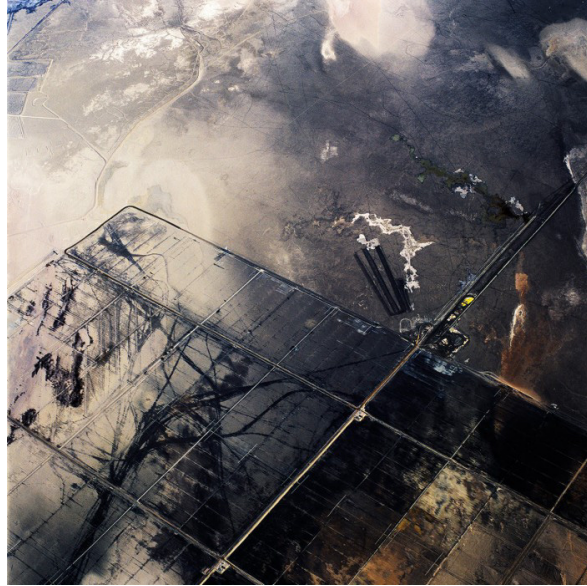

The Lake Forest
David Maisel, 2001



Source: Science Museum

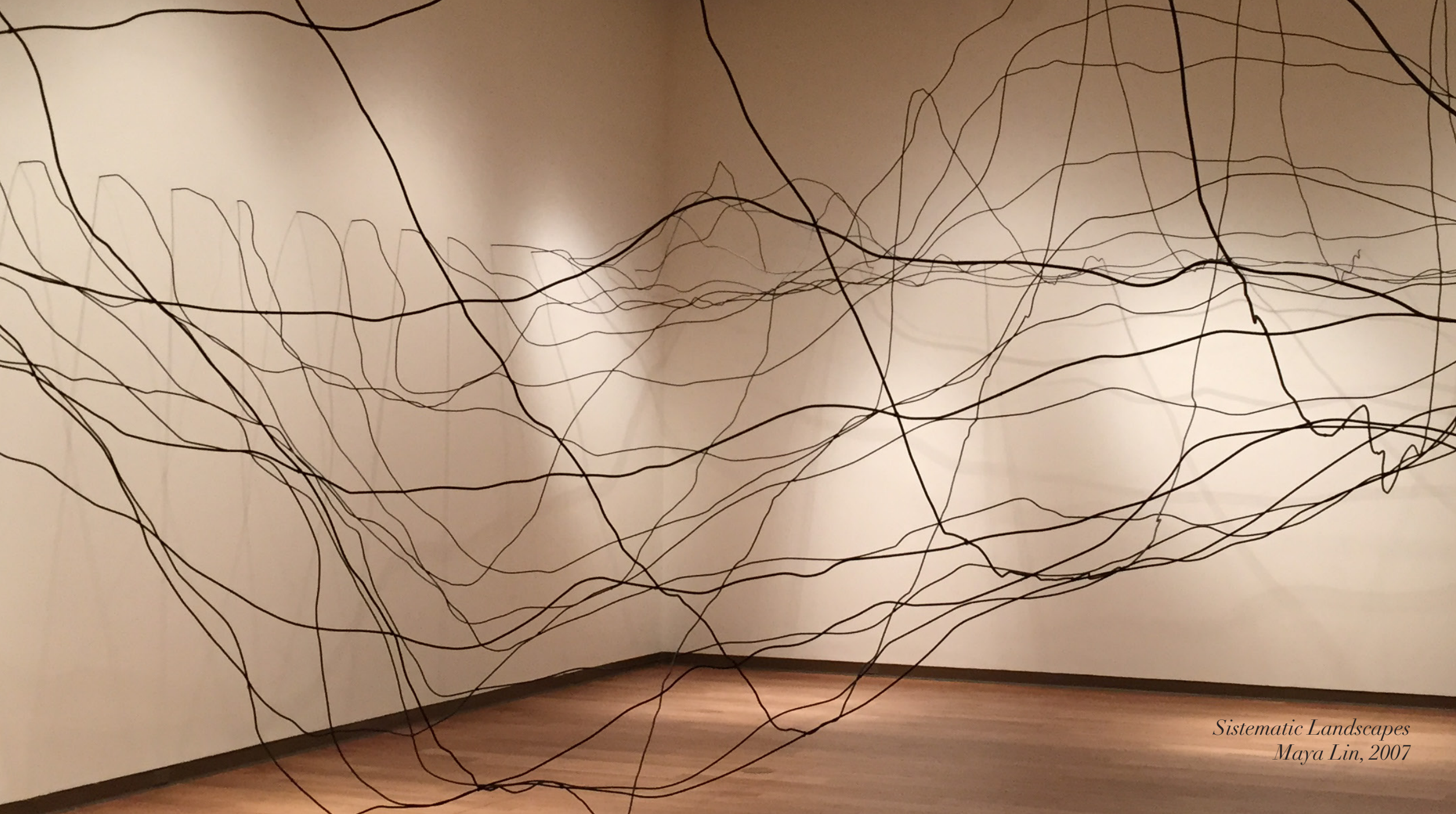

Sistematic Landscapes
Maya Lin, 2007



Pin River
Maya Lin, 2013

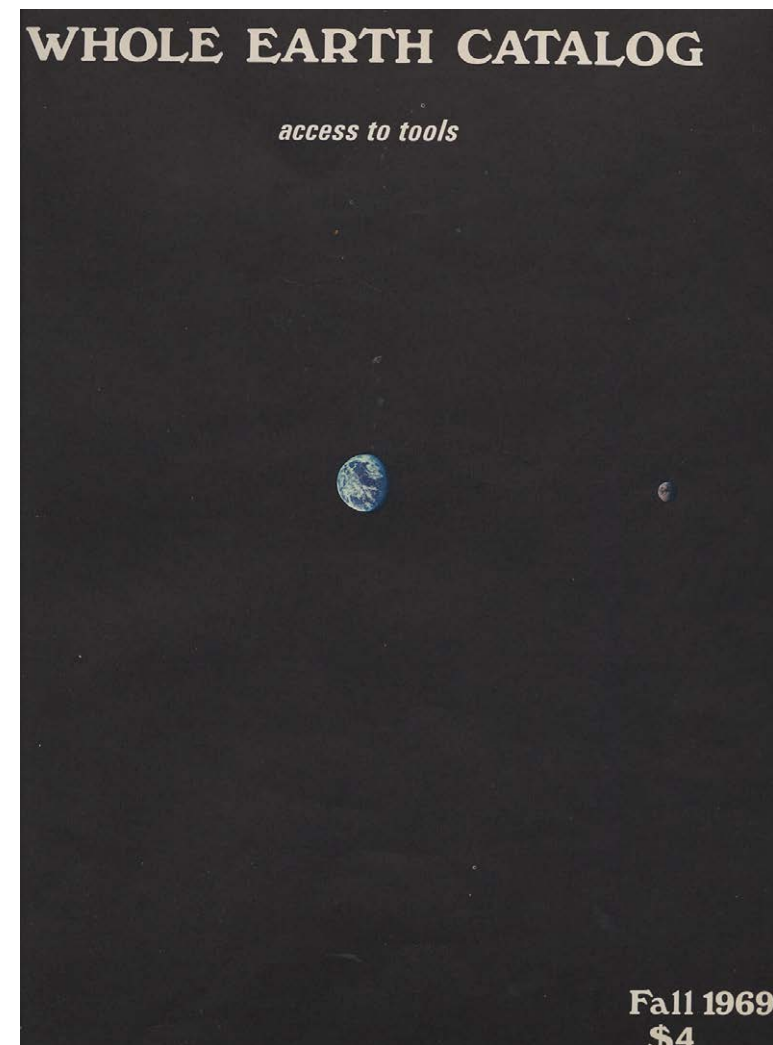
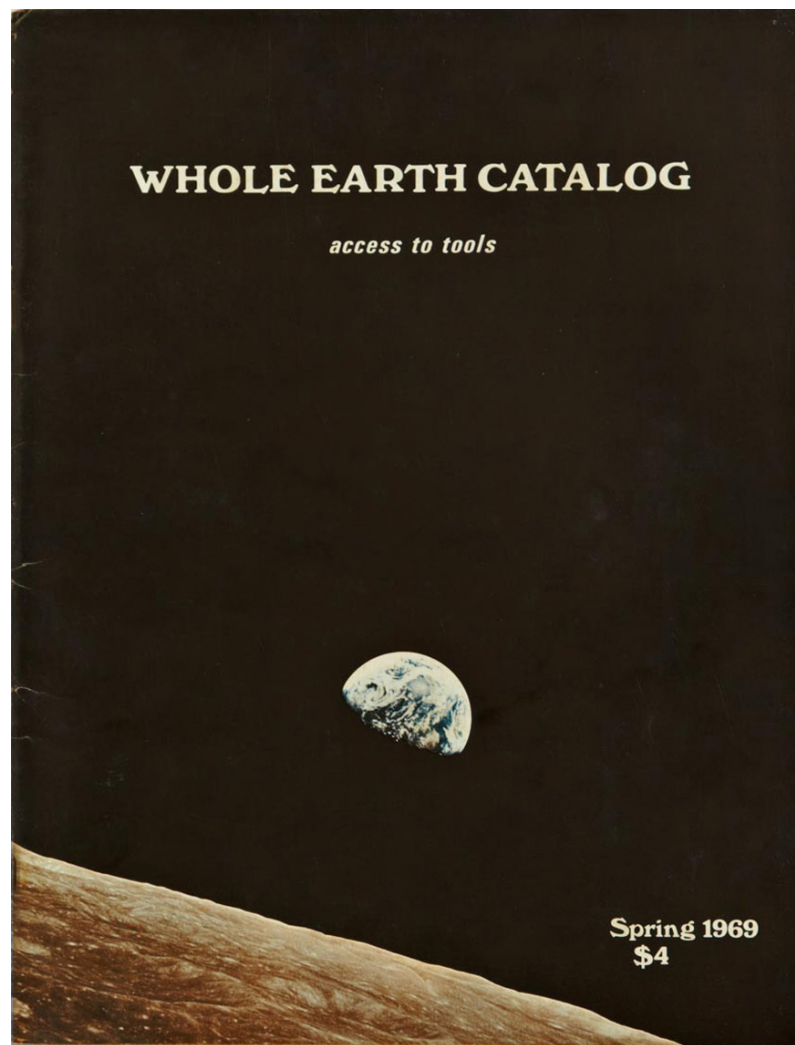
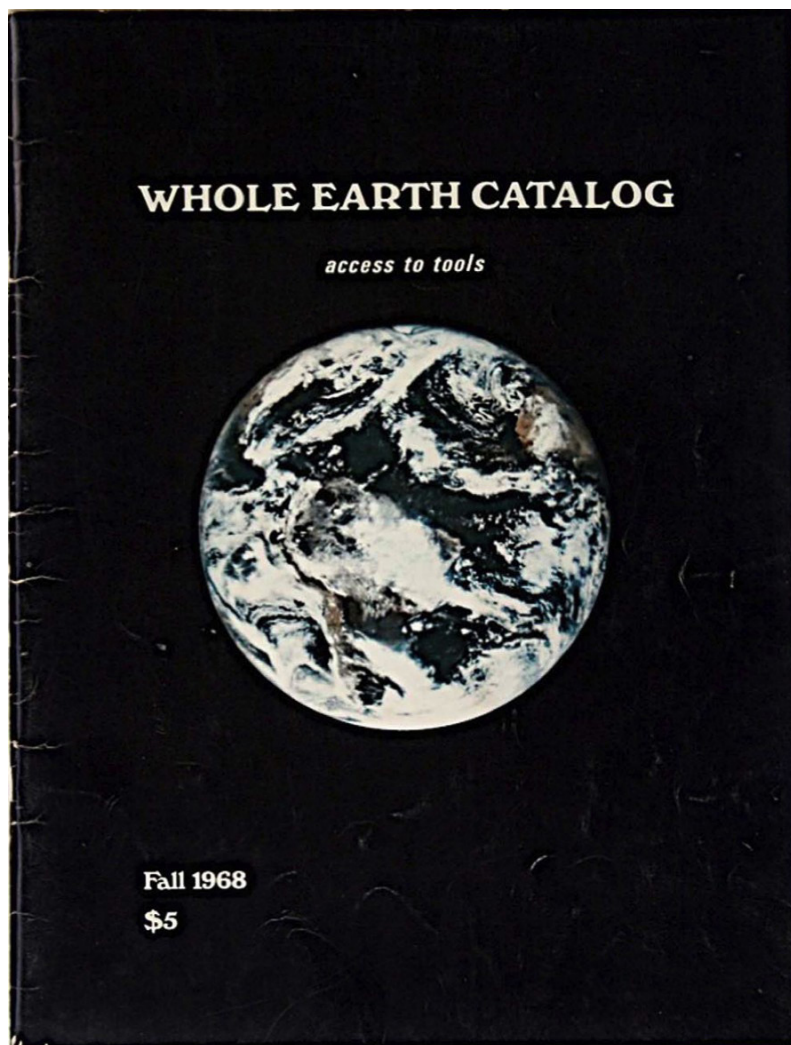

*Whole Earth Catalog
Stewart Brand (ed.), 1960s*

3.

Making the Geologic Now

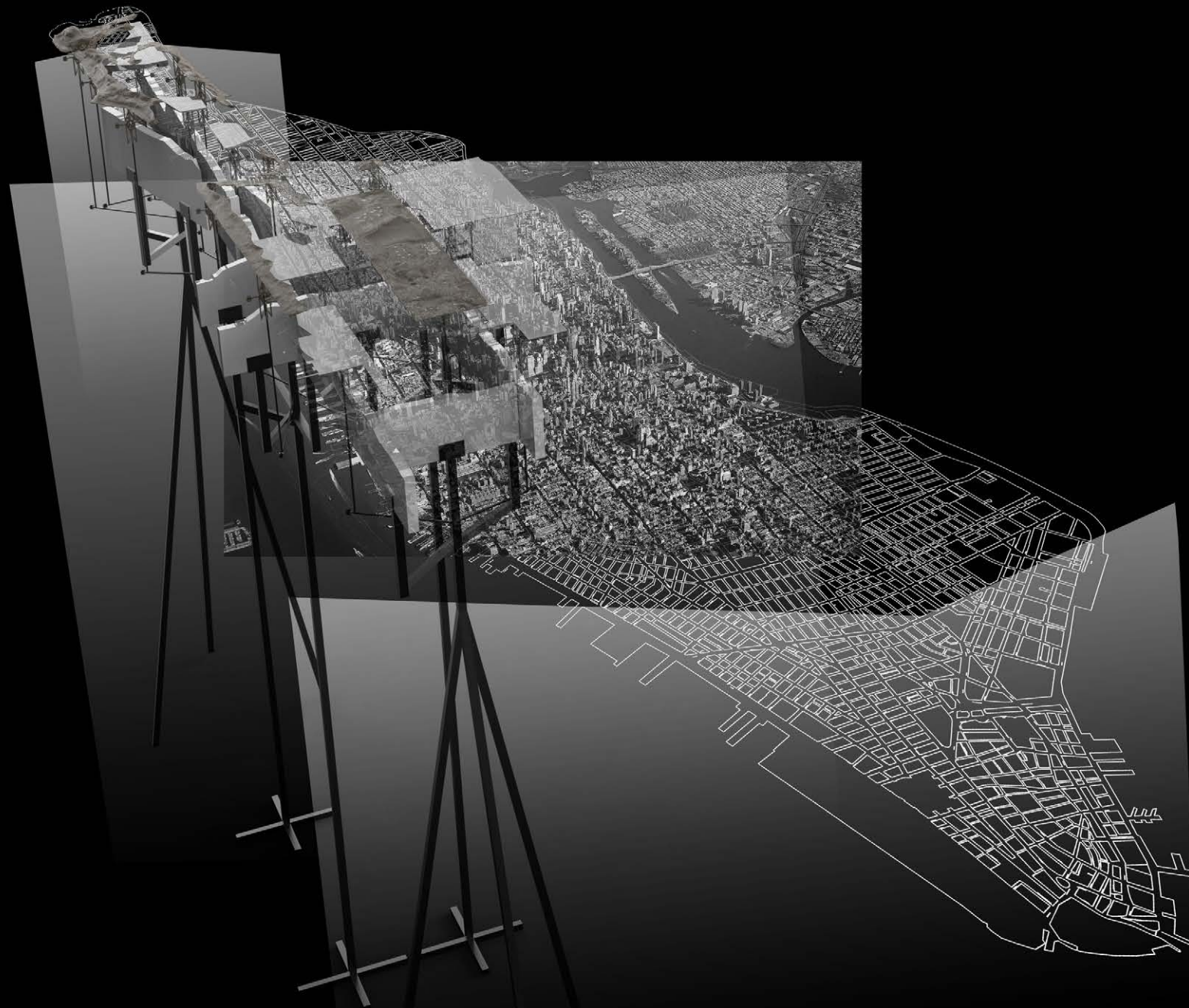

Manhattan's Geologic Delineations
Tiago Torres-Campos, 2015

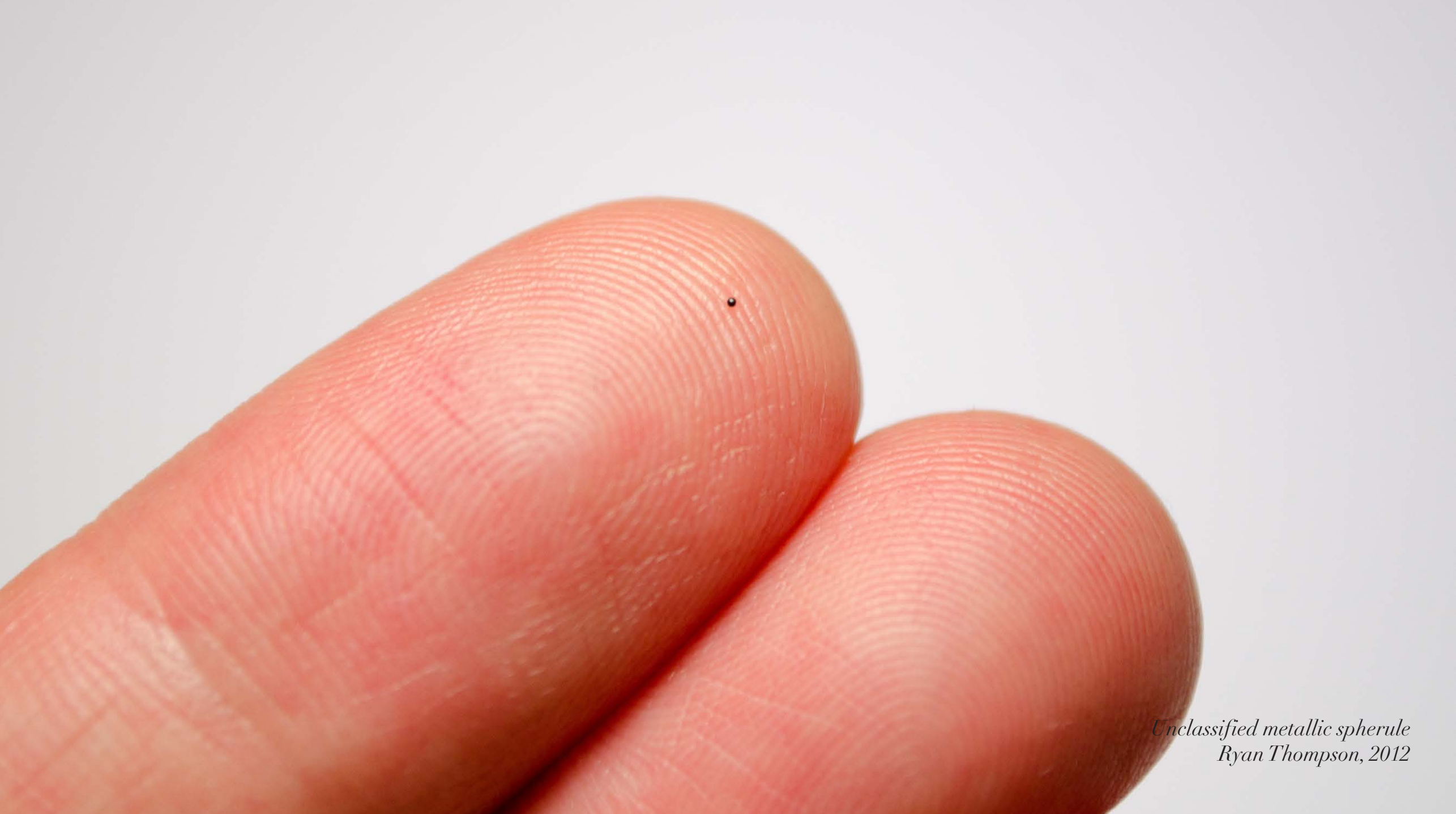

*Unclassified metallic spherule
Ryan Thompson, 2012*



A Line Describing the Sun
William Lamson, 2012



A Line Describing the Sun
William Lamson, 2012



Surface Tension
Smout Allen

4.

Museums, Time Capsules & Provocateurs



Desert Cloud
Graham Stevens, 1972



Wood Worms
Zimoun, 2009



Animal Superpowers
Chris Woebken, 2008



*Sinkhole in downtown Guatemala City
May 2010*

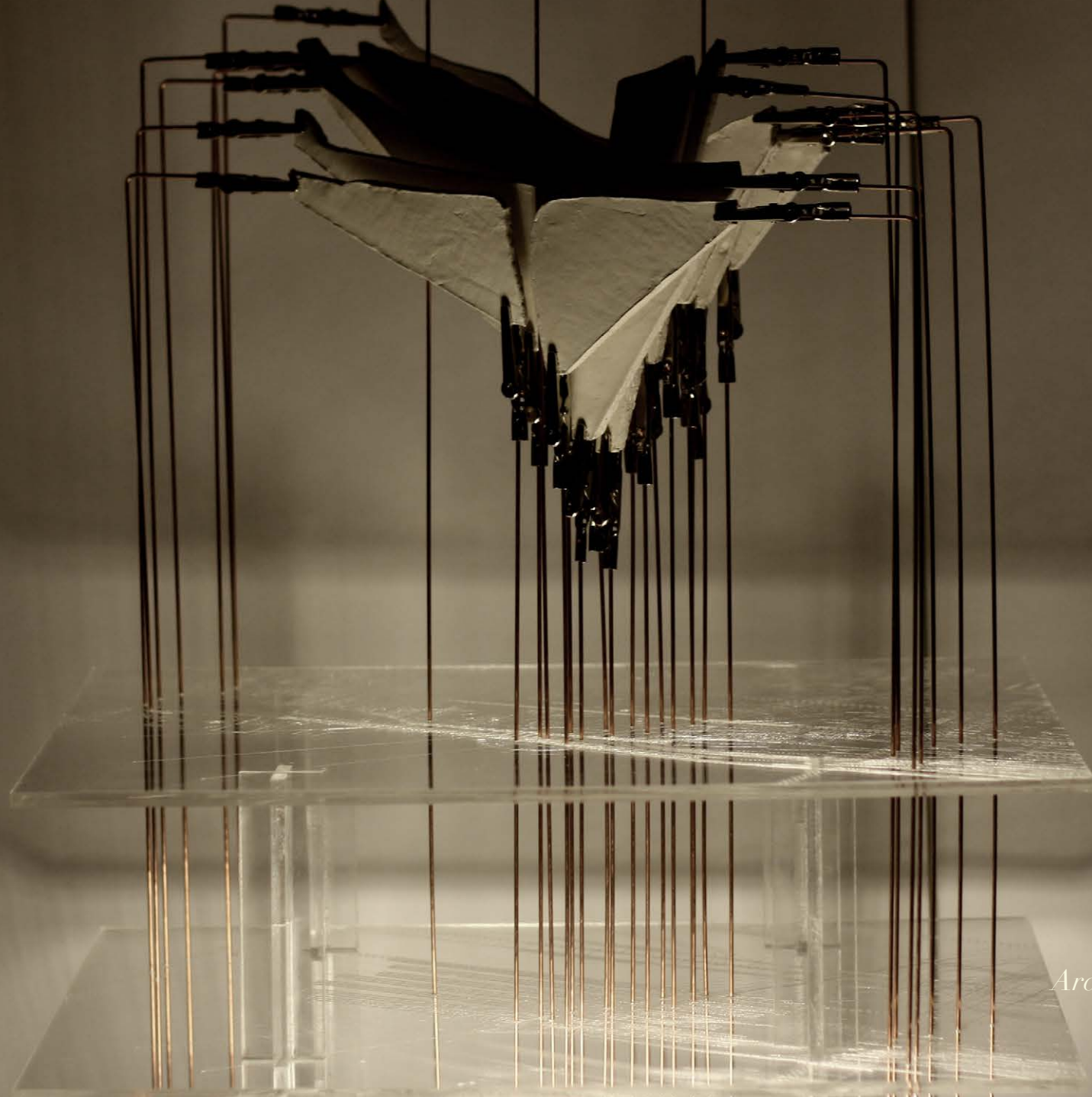

Architectural Inventions for the Faults
Tiago Torres-Campos, 2016

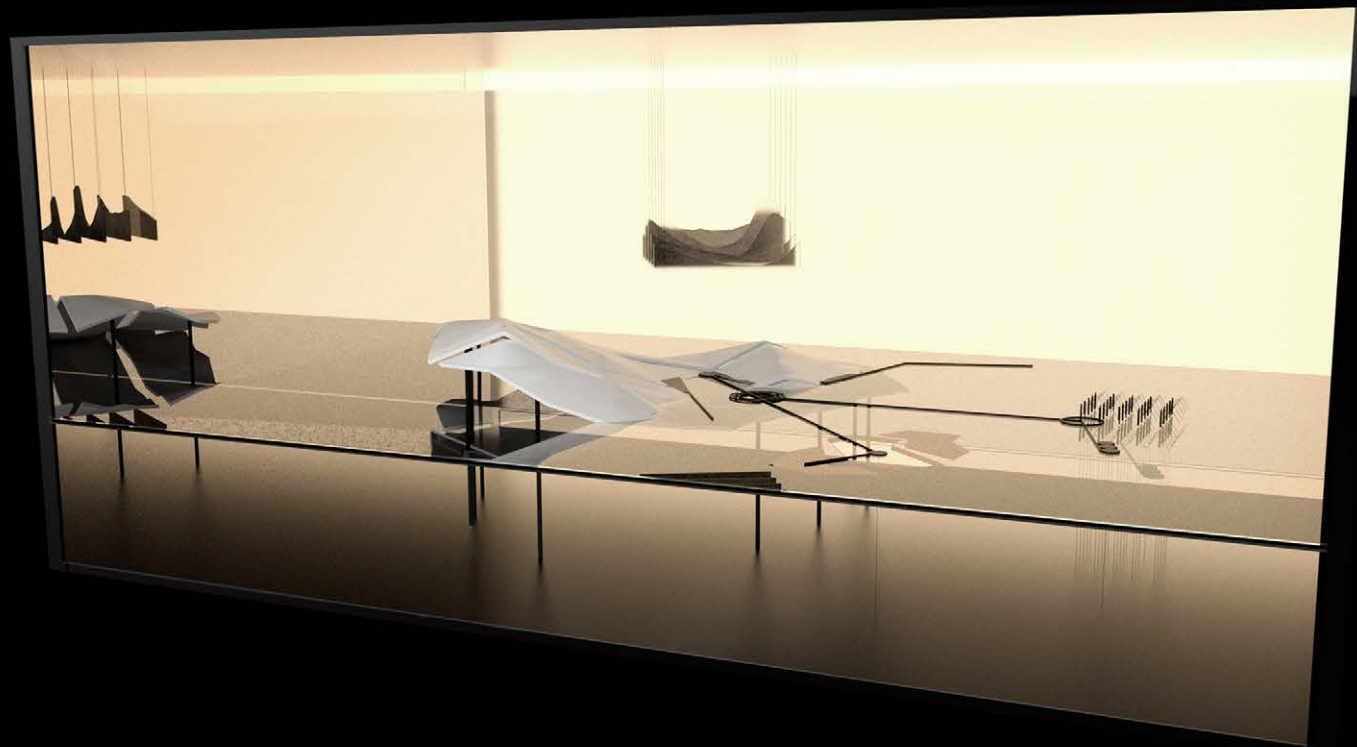

LANDSCAPES OF THE ANTHROPOCENE

Encounters in More-than-Human Worlds

Future Architecture

*Tiago Torres-Campos
tiago.t.campos@ed.ac.uk*